

## CE-FH Series

Long Life



- 105°C, 2000 to 5000hrs.
- Solvent proof (within 2 minutes)

### Specifications

Items		Specifications					
Rated voltage (V)		6.3	10	16	25	35	50
Category temperature range (°C)		-40 to +105					
Capacitance tolerance (%)		±20 (120Hz/20°C)					
Tangent of loss angle (tanδ) (MAX.) (120Hz/20°C)		0.30	0.24	0.20	0.16	0.14	0.14
		When rated capacitance exceeds 1000μF, add 0.02 to the value above for each 1000μF increase.					
Leakage current (L.C.) (μA/after 2min.) (MAX.)		The greater value of either 0.01CV or 3					
Impedance (120Hz) ratio at low temperature (MAX.)	Z <sub>-25°C</sub> /Z <sub>20°C</sub>	4	3	2	2	2	2
	Z <sub>-40°C</sub> /Z <sub>20°C</sub>	8	6	4	4	3	3
Endurance 105°C	Test	φ4 to φ6.3 : 2000 hrs., φ8 to φ10 : 3000 hrs., φ12.5 to φ16 : 5000 hrs.					
rated voltage applied (With the rated ripple current)	ΔC/C	Within ±25% of the initial value					
	tanδ	≤ 2.5 times the initial specified value					
	L.C.	≤ The initial specified value					

### Marking, Dimensions

(Unit : mm)

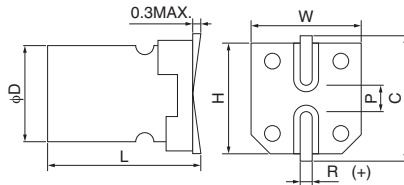
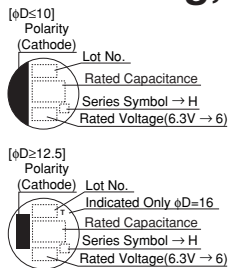

A pressure relief vent is attached to products over φD=8

D <sup>+0.5MAX.</sup>	L <sup>±0.3</sup>	W <sup>+0.2</sup>	H <sup>+0.2</sup>	C <sup>+0.2</sup>	R	P <sup>+0.2</sup>
4	6.0	4.3	4.3	5.0	0.5 to 0.8	1.0
5	6.0	5.3	5.3	6.0	0.5 to 0.8	1.4
6.3	6.0	6.6	6.6	7.3	0.5 to 0.8	2.2
6.3	7.7	6.6	6.6	7.3	0.5 to 0.8	2.2
8	10.2	8.3	8.3	9.0	0.7 to 1.0	3.2
10	10.2	10.3	10.3	11.0	1.1 to 1.4	4.6
12.5	13.5 ±0.5	12.8	12.8	13.5	1.1 to 1.4	4.6
16	16.5 ±0.5	16.3	16.3	17.3	1.8 to 2.1	7.0

### Size List, Rated Ripple Current

μF	6.3		10		16		25		35		50	
0.10											4 x 6.0	0.7
0.22											4 x 6.0	1.6
0.33											4 x 6.0	2.5
0.47											4 x 6.0	3.5
1.0											4 x 6.0	7
2.2											4 x 6.0	11
3.3											4 x 6.0	13
4.7							4 x 6.0	13	4 x 6.0	15	5 x 6.0	19
10					4 x 6.0	18	5 x 6.0	23	5 x 6.0	25	6.3 x 6.0	32
22	4 x 6.0	22	5 x 6.0	27	5 x 6.0	30	6.3 x 6.0	42	6.3 x 6.0	44	6.3 x 7.7	60
33	5 x 6.0	30	5 x 6.0	35	6.3 x 6.0	44	6.3 x 6.0	58	6.3 x 7.7	77	8 x 10.2	140
47	5 x 6.0	36	6.3 x 6.0	46	6.3 x 6.0	60	6.3 x 7.7	91	8 x 10.2	150	8 x 10.2	150
100	6.3 x 6.0	67	6.3 x 6.0	62	6.3 x 7.7	95	8 x 10.2	150	8 x 10.2	160	10 x 10.2	220
220	6.3 x 7.7	105	8 x 10.2	175	8 x 10.2	175	8 x 10.2	195	10 x 10.2	290	12.5 x 13.5	340
330	8 x 10.2	195	8 x 10.2	195	8 x 10.2	210	10 x 10.2	290	12.5 x 13.5	380		
470	8 x 10.2	210	8 x 10.2	210	10 x 10.2	290	12.5 x 13.5	400			16 x 16.5	610
680			10 x 10.2	300			12.5 x 13.5	415				
1000	10 x 10.2	300			12.5 x 13.5	440			16 x 16.5	620		
1500			12.5 x 13.5	480			16 x 16.5	720				
2200	12.5 x 13.5	490			16 x 16.5	785						
3300			16 x 16.5	820								
4700	16 x 16.5	860										

Model No.

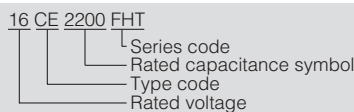
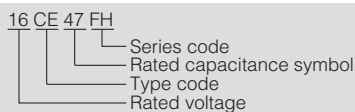

Case size ; φD x L (mm)  
16 x 16.5 ; CE-FHT series

Rated ripple current  
mAr.m.s. (120Hz, 105°C)