

CE-LX Series

Low Impedance
Long Life



- 105°C, 2000 to 5000hrs.
- Solvent proof (within 2 minutes)

Specifications

Items	Specifications					
Rated voltage (V)	6.3	10	16	25	35	50
Category temperature range (°C)	-55 to +105					
Capacitance tolerance (%)	±20 (120Hz/20°C)					
Tangent of loss angle (tanδ) (MAX.) (120Hz/20°C)	φ4 to φ6.3	0.26	0.20	0.16	0.14	0.12
	φ8 to φ16	0.28	0.24	0.22	0.16	0.14
When rated capacitance exceeds 1000μF, add 0.02 to the value above for each 1000μF increase.						
Leakage current (L.C.) (μA/after 2min.) (MAX.)	The greater value of either 0.01CV or 3					
Impedance (120Hz) ratio at low temperature (MAX.)	Z-40°C/Z20°C	3	3	3	3	3
	Z-55°C/Z20°C	4	4	4	3	3
Endurance 105°C rated voltage applied (With the rated ripple current)	Test	φ4 to φ6.3 : 2000hrs., φ8 to φ16 : 5000hrs.				
	ΔC/C	Within ±30% of the initial value				
	tanδ	≤ 3 times the initial specified value				
	L.C.	≤ The initial specified value				

Marking, Dimensions

(Unit : mm)

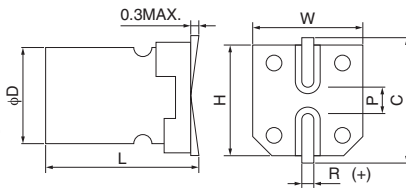
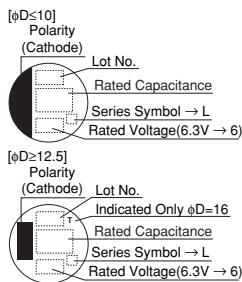

D ^{±0.5MAX.}	L ^{±0.3}	W ^{±0.2}	H ^{±0.2}	C ^{±0.2}	R	P ^{±0.2}
4	6.0	4.3	4.3	5.0	0.5 to 0.8	1.0
5	6.0	5.3	5.3	6.0	0.5 to 0.8	1.4
6.3	6.0	6.6	6.6	7.3	0.5 to 0.8	2.2
6.3	7.7	6.6	6.6	7.3	0.5 to 0.8	2.2
8	10.2	8.3	8.3	9.0	0.7 to 1.0	3.2
10	10.2	10.3	10.3	11.0	1.1 to 1.4	4.6
12.5	13.5 ±0.5	12.8	12.8	13.5	1.1 to 1.4	4.6
16	16.5 ±0.5	16.3	16.3	17.3	1.8 to 2.1	7.0

Size List, Impedance, Rated Ripple Current

V	6.3	10	16	25	35	50
4.7					4 x 6.0 1.45 90	4 x 6.0 2.9 60
10				4 x 6.0 1.45 90	5 x 6.0 0.70 170	6.3 x 6.0 0.88 165
15			4 x 6.0 1.45 90	5 x 6.0 0.70 170	5 x 6.0 0.70 170	6.3 x 6.0 0.88 165
22		4 x 6.0 1.45 90	5 x 6.0 0.70 170	5 x 6.0 0.70 170	5 x 6.0 0.70 170	6.3 x 6.0 0.88 165
27	4 x 6.0 1.45 90	5 x 6.0 0.70 170	5 x 6.0 0.70 170	6.3 x 6.0 0.39 250	6.3 x 6.0 0.39 250	6.3 x 7.7 0.68 195
33	5 x 6.0 0.70 170	5 x 6.0 0.70 170	6.3 x 6.0 0.39 250	6.3 x 6.0 0.39 250	6.3 x 6.0 0.39 250	6.3 x 7.7 0.68 195
47	5 x 6.0 0.70 170	6.3 x 6.0 0.39 250	6.3 x 6.0 0.39 250	6.3 x 6.0 0.39 250	6.3 x 6.0 0.39 250	6.3 x 7.7 0.68 195
56	5 x 6.0 0.70 170	6.3 x 6.0 0.39 250	6.3 x 6.0 0.39 250	6.3 x 6.0 0.39 250	6.3 x 7.7 0.30 300	8 x 10.2 0.34 300
68	6.3 x 6.0 0.39 250	6.3 x 6.0 0.39 250	6.3 x 6.0 0.39 250	6.3 x 6.0 0.39 250	6.3 x 7.7 0.30 300	8 x 10.2 0.34 300
100	6.3 x 6.0 0.39 250	6.3 x 6.0 0.39 250	6.3 x 6.0 0.39 250	6.3 x 7.7 0.30 300	8 x 10.2 0.17 450	8 x 10.2 0.34 300
150	6.3 x 6.0 0.39 250	6.3 x 6.0 0.39 250	6.3 x 7.7 0.30 300	8 x 10.2 0.17 450	8 x 10.2 0.17 450	10 x 10.2 0.21 490
220	6.3 x 6.0 0.39 250	6.3 x 7.7 0.30 300	6.3 x 7.7 0.30 300	8 x 10.2 0.17 450	8 x 10.2 0.17 450	10 x 10.2 0.21 490
330	6.3 x 7.7 0.30 300	8 x 10.2 0.17 450	8 x 10.2 0.17 450	8 x 10.2 0.17 450	10 x 10.2 0.09 670	12.5 x 13.5 0.14 620
470	8 x 10.2 0.17 450	8 x 10.2 0.17 450	8 x 10.2 0.17 450	10 x 10.2 0.09 670	12.5 x 13.5 0.066 900	16 x 16.5 0.073 1610
680	8 x 10.2 0.17 450	10 x 10.2 0.09 670	10 x 10.2 0.09 670	12.5 x 13.5 0.066 900	12.5 x 13.5 0.066 900	16 x 16.5 0.073 1610
1000	8 x 10.2 0.17 450	10 x 10.2 0.09 670	12.5 x 13.5 0.066 900			
1500	10 x 10.2 0.09 670	12.5 x 13.5 0.066 900			16 x 16.5 0.035 1800	16 x 16.5 0.035 1800
2200	12.5 x 13.5 0.066 900				16 x 16.5 0.035 1800	
3300			16 x 16.5 0.035 1800			
4700		16 x 16.5 0.035 1800				
6800	16 x 16.5 0.035 1800					

16 x 16.5; CE-LXT series

Model No.

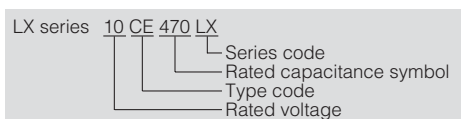

Case size ; φD x L (mm)

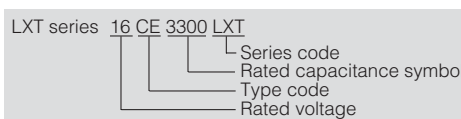

Rated ripple current mAr.m.s. (100kHz, 105°C)

Impedance (Ω) MAX. at 100kHz, 20°C